

Instruction guide for using Metoject® PEN / Metex® PEN

- This instruction guide does not replace the patient information leaflet. Please read the patient information leaflet carefully before starting your injection.
- Please remember that Metoject® PEN/ Metex® PEN is administered only once weekly.
- Wash your hands very carefully before injection and remove the pen from its packaging.

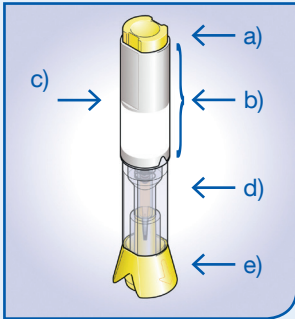

- a) Injection button
- b) Handling area
- c) Label with colour code
- d) Transparent control zone
- e) Cap

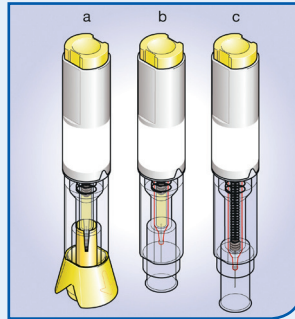

- a) With cap before injection
- b) After cap removal before injection
- c) After injection

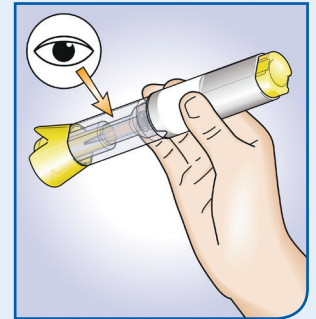

- Please check the pen through the transparent control zone before using it.

Steps to self-injection

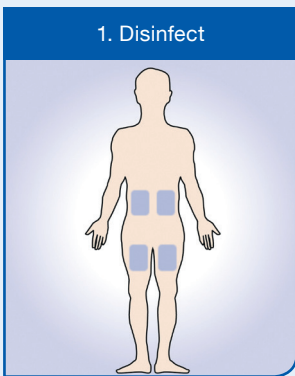

- Injection zones:
Abdomen or upper thighs
- Use the included alcohol pad to disinfect the chosen injection site.

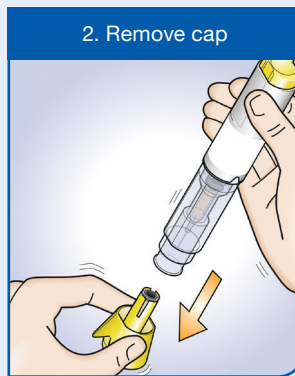

- Pull the yellow cap off in a downwards motion.

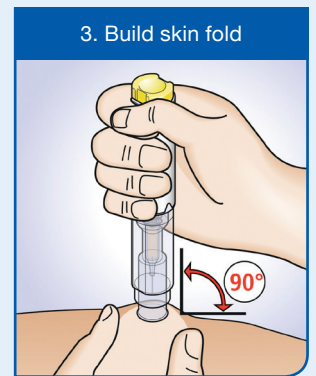

- With your free hand, gently build a skin fold.
- Place the pen on your skin at a 90 degree angle.

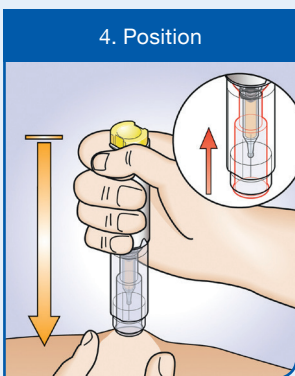

- To unlock the injection button, press the pen gently onto the skin fold.
- Hold the pen firmly on your skin during the injection process.

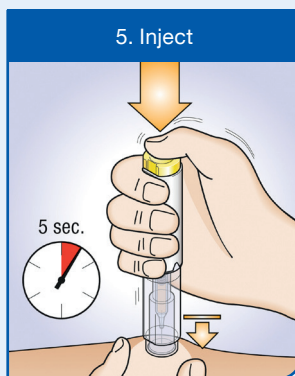

- Press the button to initiate the injection.
- You will hear a click which indicates the start of the injection.
- Wait 5 seconds until all of the fluid is injected.

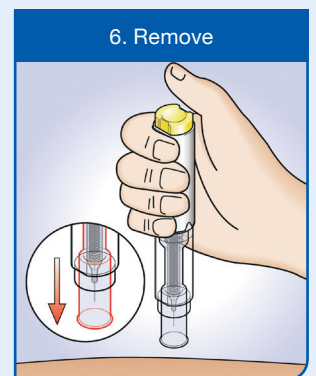

- As soon as there is no remaining fluid in the pen release the skin and remove the pen from your skin.
- The needle protection shield will automatically slide over the needle and lock in place.